

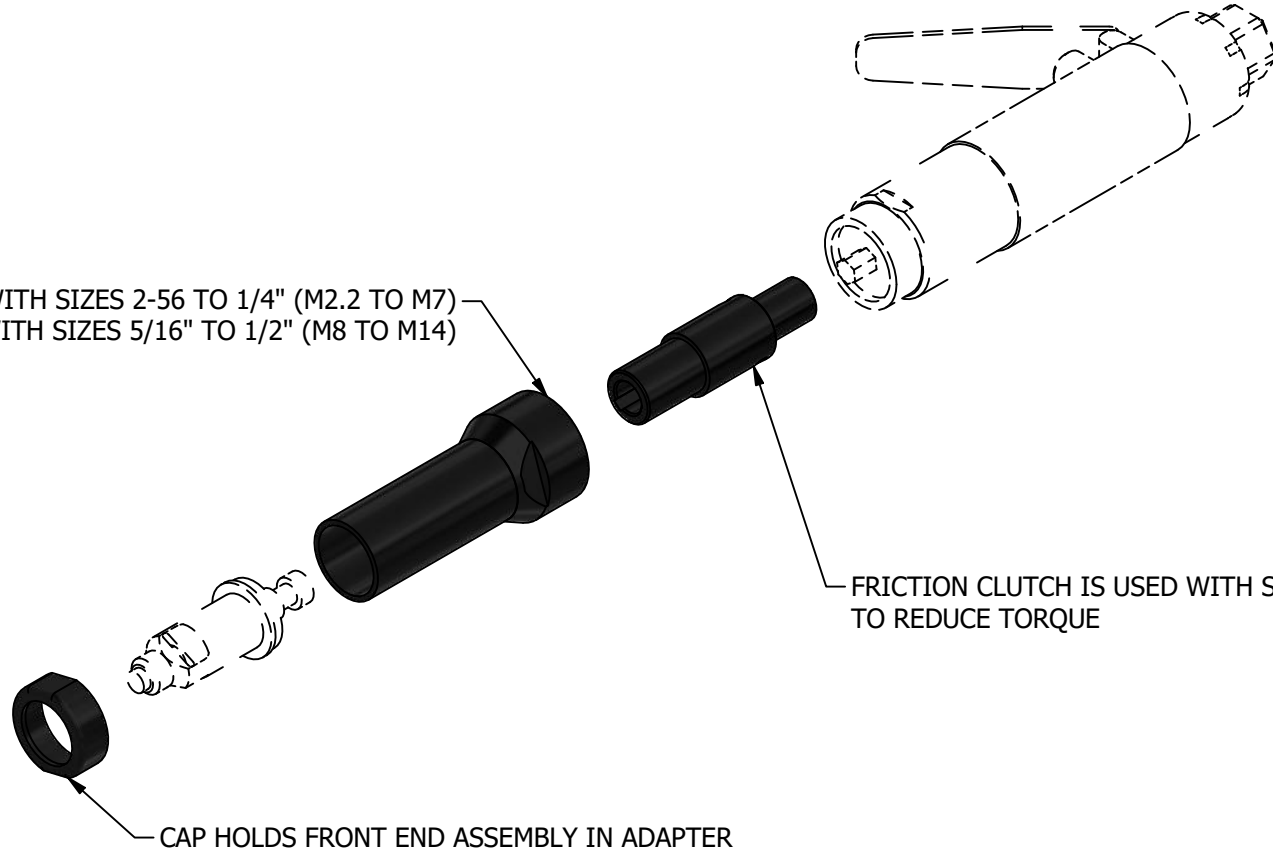

- SMALL ADAPTER IS USED WITH SIZES 2-56 TO 1/4" (M2.2 TO M7)
- LARGE ADAPTER IS USED WITH SIZES 5/16" TO 1/2" (M8 TO M14)



FRICION CLUTCH IS USED WITH SMALL ADAPTER TO REDUCE TORQUE

CAP HOLDS FRONT END ASSEMBLY IN ADAPTER

<i>Date:</i> 7/30/2020	<i>Tolerance:</i> .00.....±.010 DECIMAL: .000.....±.005 .0000.....±.0005	<i>Drawn By:</i> Adam	<i>Option No.:</i>
---------------------------	---	--------------------------	--------------------

<i>Name:</i> Helicoil Motor: Adapter and Friction Clutch
---

<i>Material Specs:</i>	<i>Sheet:</i> 1 OF 1
------------------------	-------------------------

<b>Flex</b>  <b>arm</b> Tapping & Assembly Arm Solutions	<i>Part No.:</i>
---	------------------